

# QUICK START

## CHARGING

1. Attach the magnetic pins on the charging cord to the magnetic charging ports located on the side of the Voice Clip. Make sure the charging cradle snaps into place & is securely attached to the unit.
2. Be sure the pins are aligned, then insert the other end of the charging cord into a USB port or AC adapter (included).

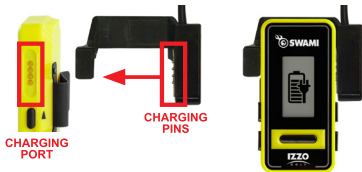

## BUTTON DIAGRAM

- A. [POWER / BACK] - **HOLD** to Power On/Off. **Press & Release** to return to a previous screen.
- B. [OK] - **Press & Release** to select options.
- C. [UP] - **Press & Release** to scroll. **HOLD** while in **Golf Mode** to access **Scorecard**.
- D. [DOWN] - **Press & Release** to scroll. **HOLD** while in **Golf Mode** to access **Shot Distance** screen.
- E. [VOICE] - **Press & Release** to receive the audio distance reading to the center of the green while in **Golf Mode**. **Press & Hold** to receive the audio distance reading to the front & back of the green while in **Golf Mode**.

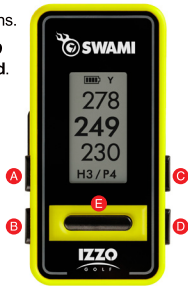

To view complete user manual visit: [www.SwamiGPS.com/product-support](http://www.SwamiGPS.com/product-support)

## GOLF MODE

1. From **Time Screen**, **Press & Release** the [ **DOWN** ] button to display **Golf Mode (A)**.
2. **Press & Release** the [ **OK** ] button to select **Golf Mode**.
3. Device will begin searching for satellite signal (**Press & Release** the [ **BACK** ] button to cancel).
4. Once satellite connection is established, the nearest golf courses will be listed. Use [ **UP / DOWN** ] buttons to scroll to desired course, and then **PRESS** [ **OK** ] button to select the course.
5. To end your round, **PRESS** [ **BACK** ] button. Scroll to the desired option then **PRESS** [ **OK** ] button to select.

A



- **SAVE** - Save your scorecard & exit **Golf Mode**
- **EXIT** - Exit **Golf Mode** and discard your score
- **CANCEL** - Return to your current golf round

## HORIZONTAL DISPLAY

- The Swami Voice can display distance readings horizontally while in **Golf Mode**.
- From the time screen, **PRESS** the [ **UP** ] button twice to select the display option. **PRESS** [ **OK** ] button to select.
- Select either horizontal or vertical display. The display orientation will only change while in **Golf Mode**.
- Once the display orientation is selected, **PRESS** the [ **BACK / POWER** ] button to exit.



**Note:** To set the correct time, select **Golf Mode** to connect to satellites (must be outside).